

# ST VINCENT'S PRIVATE HOSPITAL TOOWOOMBA

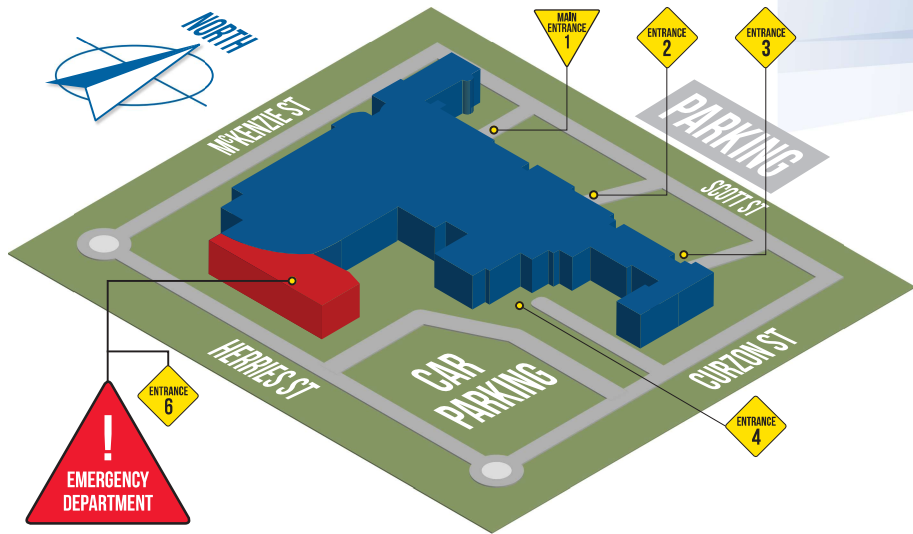

<b>Entrance 1</b>	Patient Admission
	Patient Discharge
<b>Entrance 2</b>	Medical Suites
<b>Entrance 3</b>	Medical Suites
<b>Entrance 4</b>	Medical Suites
<b>Entrance 6</b>	24-Hour Access
	Emergency Department
	Qld X-ray
	Visitors' Entrance

### INPATIENT WARDS & DEPARTMENTS

- LEVEL 2**
  - St Anne's Unit (Orthopaedics)
  - St Michael's Unit (Rehabilitation)
- LEVEL 1**
  - St Luke's Unit (Cardiac)
  - St Raphael's Unit (Medical)
- GROUND**
  - Dorothea Devine (Maternity)
  - St Damian's Unit (Surgical)
  - St Gabriel's Unit
- LOWER GROUND**
  - MAIN RECEPTION**
    - Front Admissions, Discharge
    - Chapel
    - Operating Theatres
    - Lifts to wards
    - Pathology
    - HPS Pharmacy
    - Hospital Executive

### DEPARTMENTS VIA ENTRANCE 2

- LEVEL 2**
  - Doctors' Suites
  - Clinical School
- LEVEL 1**
  - Day Unit (Wounds, Infection)
  - Breast Care Nurse Therapy
  - Doctors' Suites
- GROUND**
  - Pre Admissions
  - Doctors' Suites

### DEPARTMENTS VIA ENTRANCE 3

- HOSPITAL ENTRANCE**
  - MEDICAL SUITES

### DEPARTMENTS VIA ENTRANCE 4

- HOSPITAL ENTRANCE**
  - MEDICAL SUITES

### DEPARTMENTS VIA ENTRANCE 6

- HOSPITAL ENTRANCE**
  - VISITORS' ENTRANCE**
    - Emergency Department
    - Queensland X-Ray
    - Café
    - Florist

**NO VISITOR ACCESS TO HOSPITAL WARDS FROM MEDICAL SUITES**